



# Safety Instructions

1, 2, 3, 4, 5, 6, 7, 8, 14, 19, 28, 33, 34



Info

[www.paulmann.com](http://www.paulmann.com)

Paulmann Licht GmbH  
Quezinger Feld 2  
31832 Spöng  
Germany

[www.paulmann.com](http://www.paulmann.com)

Paulmann

Art.-Nr.: 797.26  
(+MA0326) PIN 09/17



Max. 20W



incl.

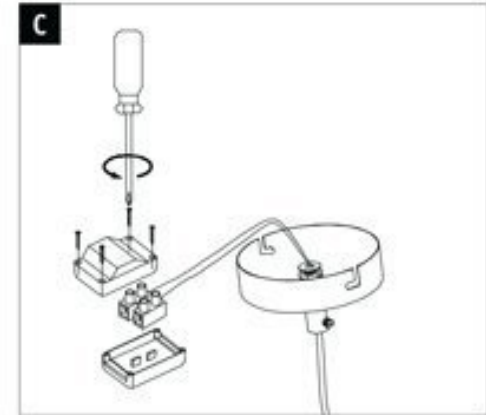
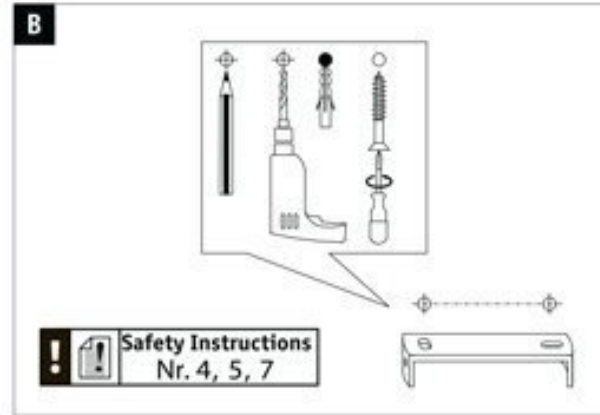
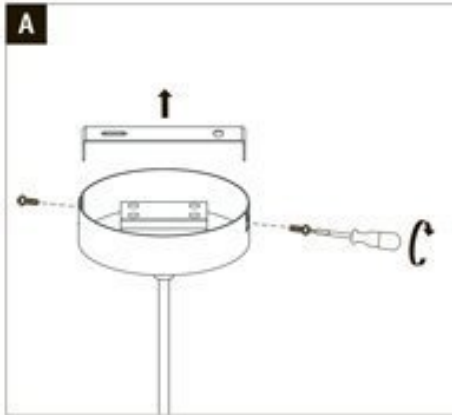

Safety Instructions  
Nr. 4, 5, 6, 7

